



## PRP DOCK LOADING & RIG SUPPLY HOSES

### SCHEMATICS OF IX INTERNAL SWAGE SYSTEM



- 1 = Hose and Ferrule  
2 = FFS Coupling  
3 = Dolly Assembly with Pull Rod

The large end of taper dolly is equal to hose inside diameter. Smaller end of taper body fits into the taper tail of coupling. Hose with ferrule is pushed over the coupling. Hose is aged

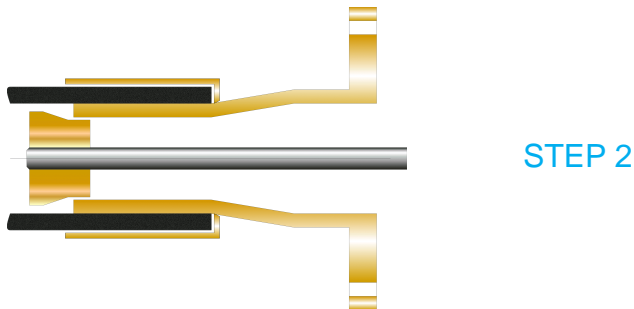

Dolly assembly is drawn through the coupling by the hydraulic ram on the swaging machine. Coupling tail piece is expanded equal to the outside diameter on the large end of the dolly taper. The tail is compressed into the hose wall, pushing it outwards and locking it between tail and ferrule. This creates a full flow passage between coupling and hose



Dolly assembly falls free at the enlarged end of the coupling and hose can be removed from the swaging machine.

**IX INTERNAL SWAGE** offers following advantages:

- full flow hose assembly
- high working pressures
- high pull off forces
- no flow obstruction with abrasive materials
- in case of food hose sanitary full flow compression prevents bacteria built up, reduces product contamination.

Suitable for CIP, SIP & COP systems

